



**AXELENT
SAFE-X**

Storerooms

DISCOVER OUR FOUR MODELS

WE OFFER FOUR DIFFERENT TYPES OF STOREROOM



CHOOSING THE RIGHT STOREROOM SYSTEM

Axelent Safe-X offers comprehensive storeroom solutions for all types of spaces. The range includes four different storeroom systems: Standard (F), Solid (FK), Solid+ (FK+) and Sheet metal – privacy protection (FP). Which type of system is best suited to you depends on your requirements as regards security and privacy protection. All storeroom types are equipped with reinforced door frame designs, and they are all easily adapted to different needs and preferences.

FLEXIBLE AND ADAPTABLE

Regardless of which storeroom system best suits you and your preferences, Axelent Safe-X is your guarantee of products and components of high quality throughout. All of our systems are designed to prevent break-ins by would-be thieves. The customer's needs and situation are always central to us, which is why we prioritise choice and flexibility. Our storeroom systems are easily adjusted and all models can be combined.

WHICH STOREROOM SOLUTION BEST SUITS ME?

The four different Axelent Safe-X storeroom systems offer solutions suited to most applications. If you choose the FP system in sheet metal for privacy protection, this does not necessarily mean that it has to be used throughout the entire storeroom. Say that your project is located in a basement corridor. You could, for example, use the FP system solely in the area facing the corridor, together with one of the standard mesh systems for the partition walls.

If, instead, you are fitting an attic space where many locked doors have to be passed before getting to the storeroom, our standard F system may be sufficient.

On the other hand, if you need a sturdier system to meet higher security requirements, you should consider the FK+ system, our premium offering. The FK+ storeroom system is certified by the Swedish Theft Prevention Association (SSF), which means that it meets the requirements developed by SSF in consultation with, among others, Insurance Sweden and other stakeholders who set security requirements for products and services. Our doors and lock systems are also designed to offer maximum flexibility. Should any problems arise with the lock/fittings on any of the mesh systems, they are easily rectified without having to remove the entire door.

EXPERTISE AND SERVICE

Here at Axelent Safe-X, we are a turnkey supplier offering an assembly service for all our products. To guarantee that the work is conducted properly and professionally, we only use our own fitters, who have expert knowledge of our systems. This ensures the delivery of products that meet strict requirements, giving you, the end customer, peace of mind knowing that the system has been properly installed. Systems installed by Axelent Safe-X's expert fitters also include one year of Safe-X Assistance free of charge.



STANDARD (F)

Storeroom walls for normal conditions.



SOLID (FK)

When high demands are stipulated for security and stability.



SOLID PLUS (FK+)

Extra strong. Tested and approved according to the SSF's standard for burglary resistant storage rooms.



SHEET METAL (FP)

When there are high demands regarding security and stability without transparency.

Things to consider before choosing a storeroom

- What is the area like where the storeroom is to be located?
Many angles, variations in height, ventilation ducts, windows or other details to take into account?
- Ceiling height. Are additional upper sections required to meet current standards regarding burglary protection, where the requirement is 15-20 cm to the ceiling?
- What is to be stored in the storerooms? What are the requirements as regards transparency?
- Do you need to supplement with different storeroom systems or is one enough? All our systems can be combined.
- What does your insurance company require when it comes to storage spaces?
- Who will take care of the assembly?
- Who is responsible for restoring the storeroom walls in the event of a burglary? How quickly?

We believe in Made in Sweden

Axelent Safe-X is part of the Axelent Group, and you can find us in Hillerstorp. We specialise in storage solutions and bicycle racks within construction, where we also offer the assembly of all our products. Thanks to our wide range of smart products and a well-developed concept, with a focus on speed and a high level of service, we are able offer our customers a comprehensive total solution.

Fast, high levels of service

Our knowledgeable staff will help you with everything from choosing the right product to creating a tailored solution to meet your needs. We can also visit your project and offer on-site advice. Through our Customer Service, you can also receive rapid support with your project.

Quotes and drawings straight away

In our SnapperWorks software, developed in-house, we can easily design your project and rapidly provide you with a drawing along with an associated quote and material specification.

Plan your project with BIM files

We offer BIM files for all our products. You can easily download them from our website.

Easy and convenient

With the aid of our experienced team of fitters, we can also offer assembly of your project. In this way, you can get your storerooms into place easily and smoothly.

Efficient production processes

Axelent has long experience of manufacturing mesh walls, and our production is automated to a high degree to manage high volumes and rapid deliveries. We keep all our standard products in stock, which enables us to guarantee fast deliveries. With Axelent's own packaging system, X-pack, your products are delivered plastic-wrapped, neat and tidy, on special pallets along with the assembly instructions.



For us, service and customised storeroom solutions are the most important factors

At Axelent Safe-X, we always start on the basis of the customer's needs and wishes. We know from experience that every customer and every project is unique in terms of its conditions and requirements. The Axelent Safe-X concept is therefore a little different from the traditional one and offers several advantages. Our basic offering comprises smart storeroom solutions, but it is our added value that makes us unique. When you buy storerooms from Axelent With Safe-X, you can expect more than just grilles.

What we offer you

1. You have a project manager who is with you all the way in your project	2. Speedy quotes and drawings	3. Rapid deliveries as all products are held in stock
4. A top quality range of products and components	5. A standard range that is easy to supplement	6. Easily assembled products with clear instructions
7. As a customer, you have access to our tailored, easy-to-use SnapperWorks CAD software	8. With our unique packaging system X-pack, we minimise delivery damage and make receiving and assembly smooth.	9. We have BIM files for all our products to help you plan with them in your project
10. We offer assembly from our experienced and knowledgeable team of fitters.	11. Our fitters are affiliated to the Swedish Building Workers' Union.	12. Axelent Assistance – we guarantee rapid action in event of damage or a burglary



We are a turnkey supplier from initial contact to assembled product.

Axelent Safe-X offers a wide range of both storerooms and bicycle racks with practical accessories. In addition, we have a team of fitters that is unique on the market. We have the largest and most experienced team of fitters in our sector. By hiring us, you therefore get a secure alternative where you can guarantee that the entire project is carried out by one and the same supplier. In addition to sales in Sweden, Axelent Safe-X delivers to the entire Nordic region.



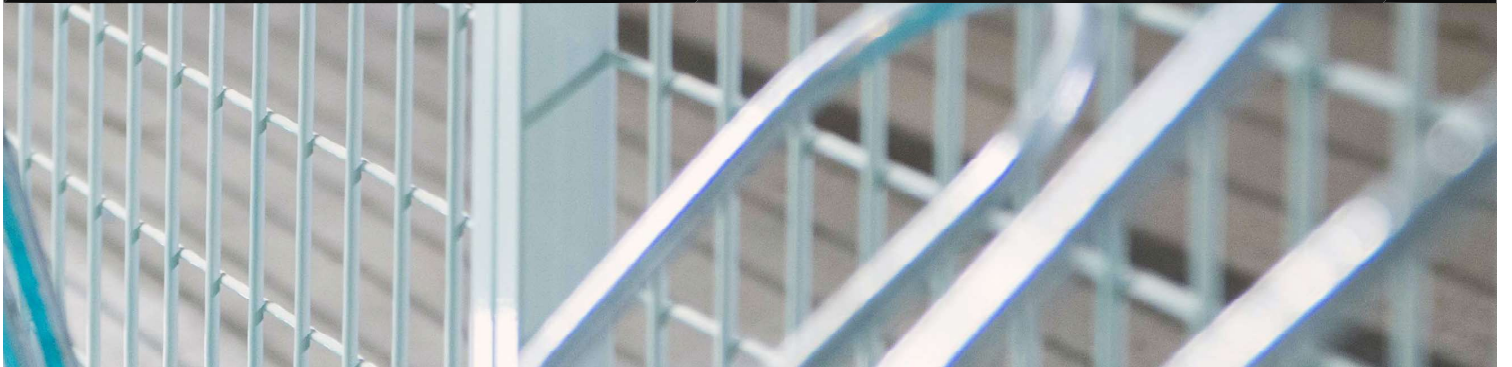

Standard storeroom - F

AN AFFORDABLE CLASSIC WITH HIGH FLEXIBILITY DURING ASSEMBLY

Our type F storeroom system is one of our best sellers, with the strength and security it provides often being sufficient. We ensure at the design stage that everything goes smoothly and quickly when the walls are in place and are ready to be fitted.

- With sturdy tubular door frame design
- Can be combined with the FK, FK+ and FP systems
- Can be cut and adapted to existing building dimensions
- Can be fitted with ceiling at heights above 3.5 metres
- The walls are painted in RAL 9018





Standard storeroom with accessories

Product description - F	
Materials & Construction	Dimensions (mm)
Tubular steel frame, wall	
Vertical tubing	19x19
Horizontal tubing	15x15
Tubular steel frame, door	
Vertical tubing	30x20
Horizontal tubing	25x15
Steel wire mesh	
Vertical wires	Ø 3.0
Horizontal wires	Ø 2.5
Mesh aperture	50x65
Door	Opening dimensions
30-4225750(1)	2000x710
30-4275900(1)	2000x860

DIMENSIONS – F			
	Item no.	Height (mm)	Width (mm)
Wall section	30-2020	2250	200
	30-2025	2250	250
	30-2035	2250	350
	30-2040	2250	400
	30-2055	2250	550
	30-2060	2250	600
	30-2080	2250	800
	30-2100	2250	1000
	30-2110	2250	1100
	30-2120	2250	1200
	30-2150	2250	1500
Recess piece	30-2002	2250	20
Door	30-4225750(*)	2250	750
	30-4225900(*)	2250	900

* Alternative locking solution
 (1) = Right/left
 (2) = Right + cover
 (3) = Left + cover
 (4) = Prepared for cylinder
 (5) = X-It, right
 (6) = X-It, left

ACCESSORIES



Padlock fitting for the F system (always included)
Can be used on all doors to lock the storeroom with a padlock.



Wire shelf
Shelf with or without clothes rail. Easy to assemble.



Number plate
Makes it easier for you to find what you are looking for. Just specify the desired number.

“ Our F storeroom system is perfect for areas that require a significant amount of adaptation on site, such as cutting angles in an attic.

MARCUS CLAEISSON, KEY ACCOUNT MANAGER, AXELENT SAFE-X



Storeroom Solid - FK

STURDIER THAN STANDARD, MAKING THE STOREROOM EXTRA STABLE AND DURABLE

Quality is made visible in our attention to details. Our type FK storeroom system has an extra strong tubular construction in both doors and walls, which makes the system extra secure and stable. Combining FK with intermediate walls from our F system is often more than enough.

- With extra strong tubular construction in both doors and walls
- Can be combined with systems F, FP and with FK+ as a partition wall
- Can be cut and adapted to existing building dimensions
- Can be fitted with ceiling at heights above 3.5 metres
- The walls are painted in RAL 9018





Storeroom Solid with accessories

Product description - FK	
Materials & Construction	Dimensions (mm)
Tubular steel frame, wall	
Vertical tubing	30x20
Horizontal tubing	25x15
Tubular steel frame, door	
Vertical tubing	30x20
Horizontal tubing	25x15
Steel wire mesh	
Vertical wires	Ø 4.0
Horizontal wires	Ø 4.0
Mesh aperture	
	50x65
Door	
	Opening dimensions
30-4225750(1)	2000x710
30-4275900(1)	2000x860

DIMENSIONS – FK			
	Item no.	Height (mm)	Width (mm)
Wall section	40-2020	2250	200
	40-2025	2250	250
	40-2035	2250	350
	40-2040	2250	400
	40-2055	2250	550
	40-2060	2250	600
	40-2080	2250	800
	40-2100	2250	1000
	40-2110	2250	1100
	40-2120	2250	1200
Recess piece	40-2150	2250	1500
	40-2002	2250	20
	40-2002	2250	20
Door	40-4225750(*)	2250	750
	40-4225900(*)	2250	900

* Alternative locking solution
 (1) = Right/left
 (2) = Right + cover
 (3) = Left + cover
 (4) = Prepared for cylinder
 (5) = X-It, right
 (6) = X-It, left

ACCESSORIES



Padlock cover for FK and FK+ (always included)
 Can be used on all doors to protect the padlock. Also available with extra-reinforced lock fittings.

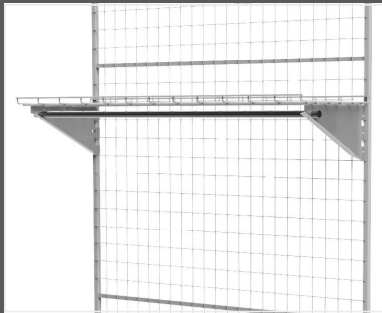

Wire shelf
 Shelf with or without clothes rail.
 Easy to assemble.



Number plate
 Makes it easier for you to find what you are looking for. Just specify the desired number.



FK is our most popular storeroom system, and is suitable when slightly higher demands are stipulated as regards security and stability.



Storeroom Solid Plus - FK+

THE STOREROOM SYSTEM WITH EXTRA HIGH SECURITY THROUGH ITS REINFORCED CONSTRUCTION

FK+ is our sturdiest storeroom system, which is suitable when higher demands are stipulated as regards security and stability. The storeroom system is approved by SSF. FK+ uses reinforced hinges, lock fittings, doors and walls.

- Tested and approved according to the SSF's standard for burglary resistant storage rooms.
- With extra hinge and lock fitting reinforcement.
- Extra-reinforced door and wall designs.
- Can be cut and adapted to existing building dimensions.
- Can be fitted with ceiling at heights above 3.5 metres.
- The walls are painted in RAL 9018.





Storeroom Solid Plus with accessories

Product description - FK+	
Materials & Construction	Dimensions (mm)
Tubular steel frame, wall	
Vertical tubing	30x20
Horizontal tubing	25x15
Tubular steel frame, door	
Vertical tubing	40x20
Horizontal tubing	35x15
Steel wire mesh	
Vertical wires	Ø 5.0
Horizontal wires	Ø 5.0
Mesh aperture	50x65
Door	Opening dimensions
45-4225750(1)	2000x710
45-4275900(1)	2000x860

DIMENSIONS – FK			
	Item no.	Height (mm)	Width (mm)
Wall section	45-2020	2250	200
	45-2025	2250	250
	45-2035	2250	350
	45-2040	2250	400
	45-2055	2250	550
	45-2060	2250	600
	45-2080	2250	800
	45-2100	2250	1000
	45-2110	2250	1100
	45-2120	2250	1200
Recess piece	45-2002	2250	20
Door	45-4225750(*)	2250	750
	45-4225900(*)	2250	900

* Alternative locking solution
 (2) = Right + cover
 (3) = Left + cover

ACCESSORIES



Padlock cover for FK and FK+ (always included)
 Can be used on all doors to protect the padlock. Also available with extra-reinforced lock fittings.

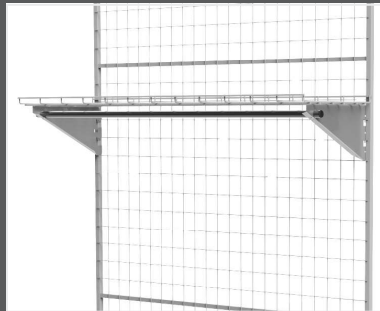

Wire shelf
 Shelf with or without clothes rail.
 Easy to assemble.



Number plate
 Makes it easier for you to find what you are looking for. Just specify the desired number.



In the event of a burglary in a type FK+ storeroom, you are protected by our Assistance service, which means that we will restore storeroom material that has been damaged in connection with the burglary. This storeroom type has been tested and approved by the Swedish Theft Prevention Association.

MARCUS CLAESSION, KEY ACCOUNT MANAGER, AXELEN SAFE-X



Storeroom Sheet metal - FP

PRIVACY-PROTECTED STOREROOM WITH STURDY CONSTRUCTION

A storage area can reveal a great deal. Or nothing at all. Here at Axelent Safe-X, we can meet all storeroom requirements. Our FP system, supplied not with mesh but with solid walls, has been developed for areas with high security and stability requirements, but where what is in the storeroom does not need to be monitored.

- Extra strong tubular door design
- Can be combined with F, FK and FK+ systems
- Can be cut and adapted to existing building dimensions
- Can be supplied with a mesh upper section and roof
- The walls are manufactured in sendzimir, the doors are painted in colour RAL 9018





Storeroom Sheet metal with accessories

Product description - FP	
Materials & Construction	Dimensions (mm)
Steel walls, sheet metal profile	
Depth of profile	30
Thickness of sheet metal	0.7
Tubular steel frame, door	
Vertical tubing	30x20
Horizontal tubing	25x15
Door	
50-7090	Opening dimensions 1870x860

DIMENSIONS – FP			
	Item no.	Height (mm)	Width (mm)
Wall section	50-2020	2000	200
	50-2040	2000	400
Recess piece	50-2019	2000	0-100
Door	50-7090	2000	900
Our doors are reversible right/left.			

ACCESSORIES



Padlock fitting for FP (standard version)
Doors for type FP have a pre-welded padlock fitting



Padlock fitting with welded protective cover
Doors for FP can also be prepared for padlocks with a padlock cover for an extra burglar-proof door.



Doors prepared for cylinder
All our storeroom doors can be ordered prepared for a cylinder, so this is also the case for doors of type FP.



Our FP storeroom system is an excellent alternative when high demands are placed on security and stability – without transparency!



Accessories

ACCESSORIES FOR OUR STOREROOMS

Here you get an overview of the accessories available for the storerooms. There are also storeroom-specific accessories, and these are specified for each storeroom in this brochure. We have also compiled important information about the situation as regards padlocks and what dimensions should be taken into account.

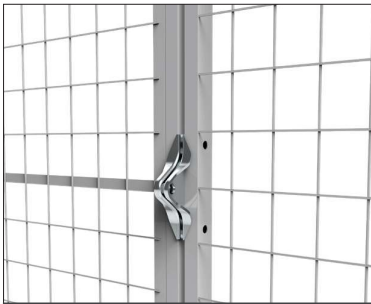

Padlock fitting (fStandard for the F system) – Can be used on all doors.



Padlock fitting with cover (Standard for FK and FK+) – Can be used on all doors to protect the padlock. Also available with extra-reinforced lock fittings (see left-hand image).



Cylinder lock – for even more secure storage



Wire shelf – Shelf with or without clothes rail. Easy to assemble, no matter which of our mesh wall systems you choose. Available for both single and double installation.

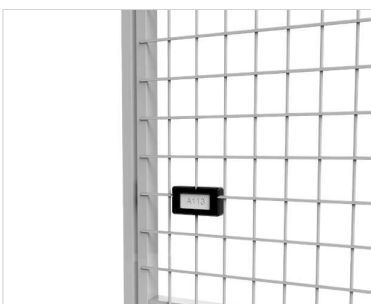

Number plate – Makes it easier for you to find what you are looking for. Specify the desired number and we'll sort it out.

Padlock information

Your apartment storeroom is delivered and assembled by Axellent Safe-X AB. In order for your home insurance to be valid, a class 2 padlock must be used.

We recommend a padlock with a shackle. You can see the dimensions below:

- A: 20–25 mm (Internal dimensions, shackle)
- B: 20–30 mm (Internal dimensions, shackle)
- C: 6–10 mm (Thickness of the shackle)



Hire us for assembly

Our team of fitters is unique on the market. We have the largest and most experienced team of fitters in our sector. With their expertise and extensive coverage across the country, you can hire us for the entire journey, from initial contact to pre-assembled product. A secure alternative where you can ensure that the entire project is carried out by one and the same supplier. We only offer this service within Sweden.

Axelent Safe-X is a turnkey supplier, offering installation of both storeroom walls and bicycle racks. There is considerable demand for this service, and just about all our customers opt to use it. It saves time and you are guaranteed to have the storeroom solution executed professionally. It is of the utmost importance for our work to be carried out safely and with a high level of quality, and for this reason all our fitters are affiliated to the Swedish Building Workers' Union.

The benefits of hiring us for assembly

- Assembly carried out with high level of quality
- Well-trained fitters who can resolve problems directly on site
- High quality materials
- High level of service throughout the organisation
- Control measurement is carried out prior to assembly
- Good price
- Flexibility

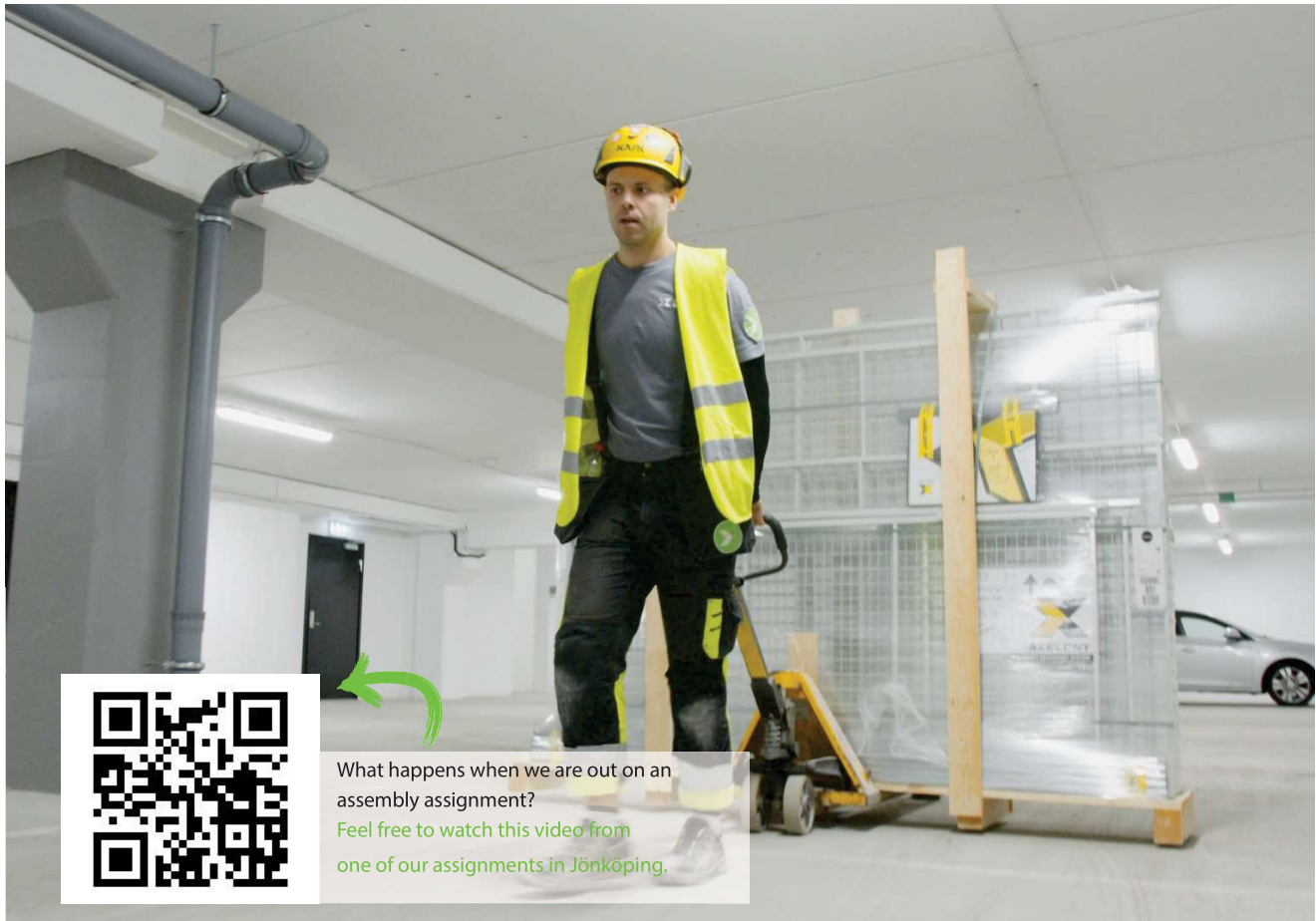

What happens when we are out on an assembly assignment?

Feel free to watch this video from one of our assignments in Jönköping.

Be inspired, plan and sketch out your project

WE WILL HELP YOU WITH XPERIENCE, SNAPPERWORKS AND BIM FILES!

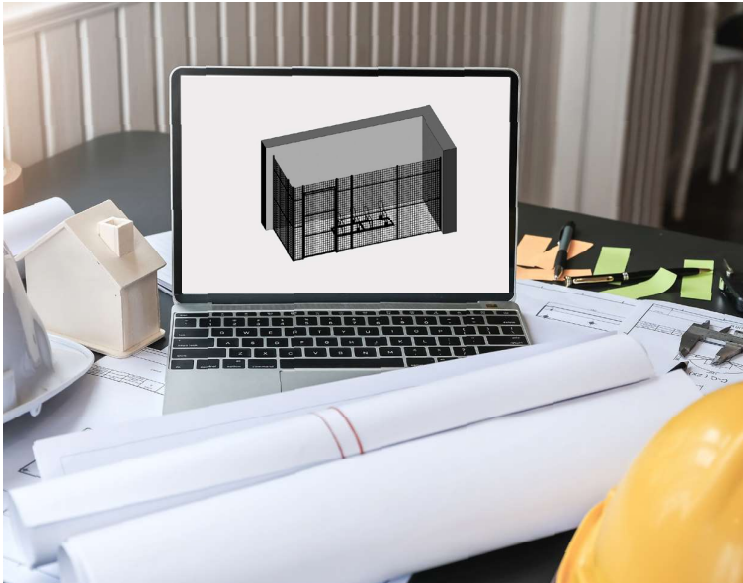

BIM FILES FOR OUR PRODUCTS

We offer all our products as BIM files, so that you can easily add the products to your sketched project. You can find our BIM files for each product on our website. This gives you the option of downloading them to include them in your CAD software. We do this because we want it to be as easy as possible for you to include our products at the same time as planning for other types of products. It should be easy to be our customer.

LEARN MORE ABOUT AND EXPERIENCE OUR PRODUCTS AT XPERIENCE

You can walk around in a virtual environment and see our storeroom products in our digital showroom, Xperience. In connection with the products, you can also watch videos, read about the various products and learn more about them.



SnapperWorks

PLAN YOUR STOREROOM PROJECT IN OUR SNAPPERWORKS TOOL

You can plan your storeroom project effortlessly with SnapperWorks, enabling you to calculate and plan your space optimally. Our skilled Customer Service staff can also help with planning using the tool. SnapperWorks is easy to use and helps you sketch out your project and plan the layout of our products. You can also import your sketch files into the system. Similarly, you can export your sketches to a STEP file to use in your own 3D CAD program. Once you have finished your sketch, you will receive a complete drawing along with a list of materials and a calculation. Using the tool is also completely free of charge.

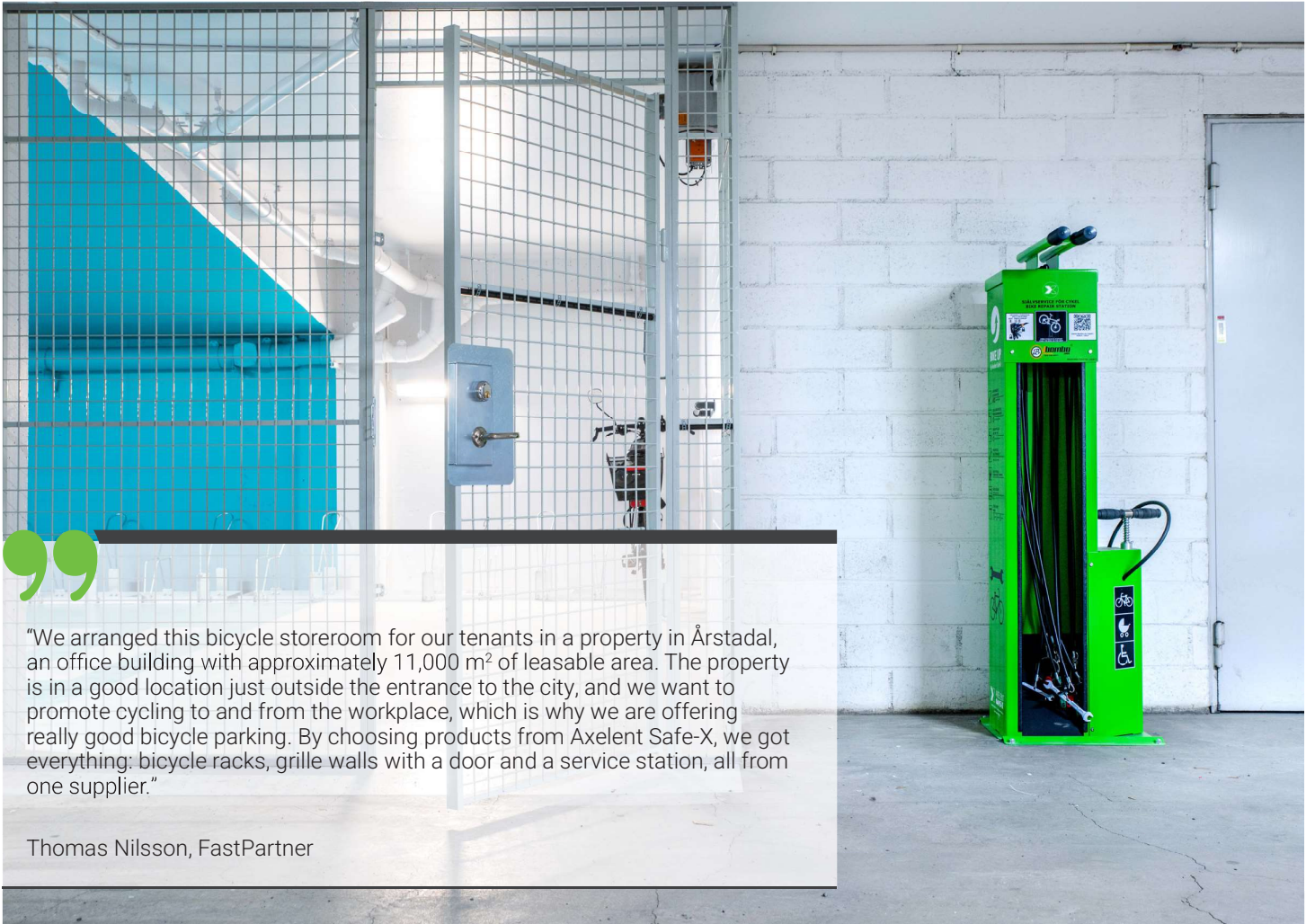

“We arranged this bicycle storeroom for our tenants in Årstadal, an office building with approximately 11,000 m² of leasable area. The property is in a good location just outside the entrance to the city, and we want to promote cycling to and from the workplace, which is why we are offering really good bicycle parking. By choosing products from Axellent Safe-X, we got everything: bicycle racks, grille walls with a door and a service station, all from one supplier.”

Thomas Nilsson, FastPartner

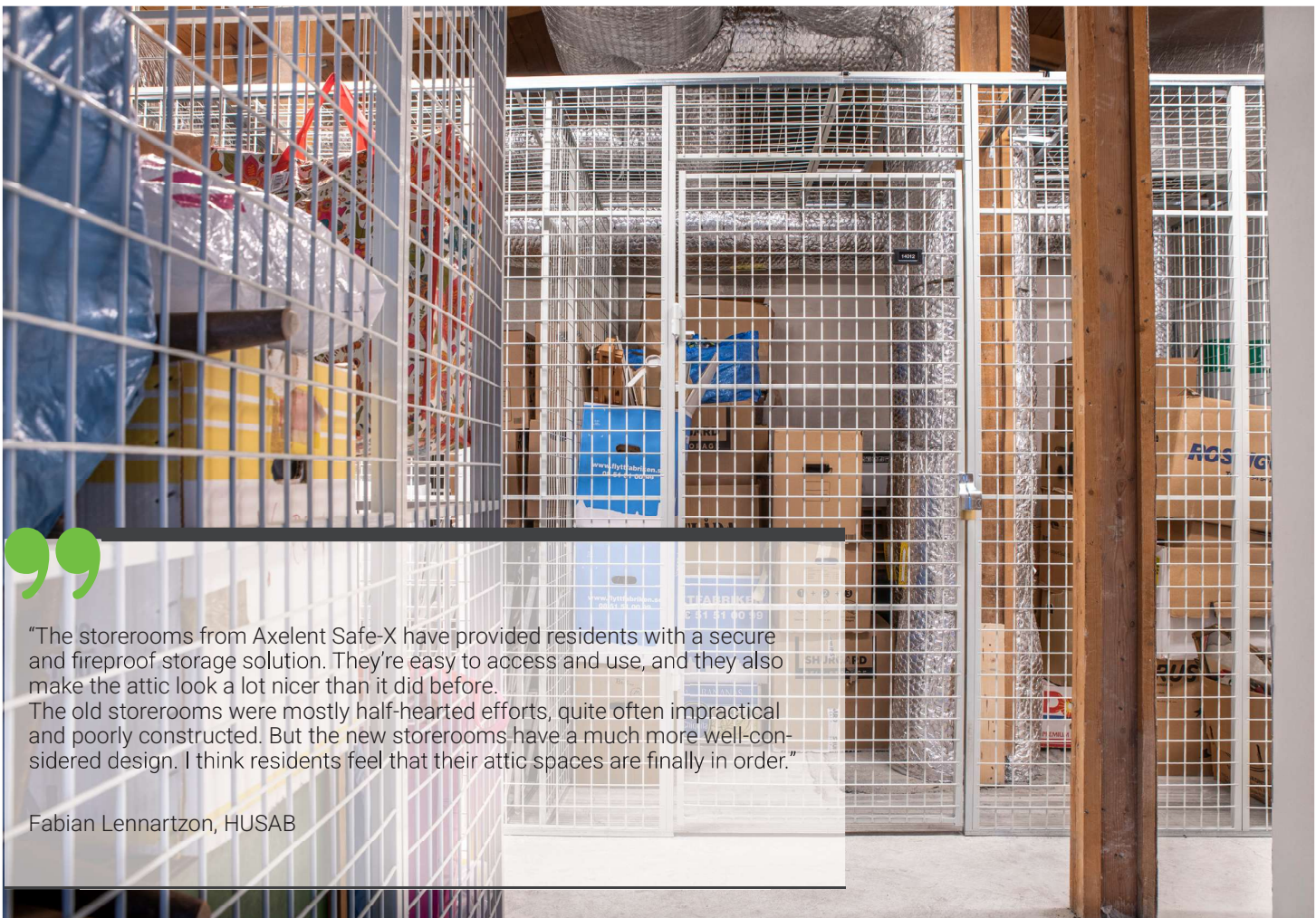

“The storerooms from Axellent Safe-X have provided residents with a secure and fireproof storage solution. They’re easy to access and use, and they also make the attic look a lot nicer than it did before. The old storerooms were mostly half-hearted efforts, quite often impractical and poorly constructed. But the new storerooms have a much more well-considered design. I think residents feel that their attic spaces are finally in order.”

Fabian Lennartzon, HUSAB

X-It Electric

COMBINE YOUR STORAGE SOLUTION WITH OUR ELECTRONIC LOCK

Our new electronic lock, the X-It Electric, is a cost-effective solution for shared storage spaces and can be used together with an existing access control system.



Commercial and residential building management requires many decisions to be made. Not only when it comes to the financial aspects or extensive ground work, but also matters related to the interior, including shared storage spaces. Which spaces should residents be able to access? What type of key solution should be used for shared spaces? How can we make things as convenient as possible for residents and the property owner alike?

It is often said that less is more, which is why Axelent has chosen to develop a lock that can easily be added to an access control system already in use. Forget having to provide several different keys for the shared areas of your building. Below we explain what the X-It series electronic lock can do for you as well as the advantages of an electric lock over a standard cylinder lock.

The difference between a standard cylinder lock and the X-It Electric

Our new lock is a part of the X-It series, and on the outside it looks very similar. What separates the X-It Electric from the other locks in the series is its electronic lock function. The locking mechanism is actuated by an electronic switch or an electronic key in the shape of a tag or a card instead of a knob. This enables you to manage access rights in buildings where the lock is used. For safety, the X-It Electric has a mechanical emergency exit function that can be activated from the inside in the event of a power failure.

Unique features of the X-It Electric

- Compatible with all electric access control systems.
- Easy installation. Cylinder lock with mechanical key that overrides the electronic function.
- Lamp to indicate whether it is locked or unlocked.
- Compatible with all of our storeroom systems.

Axellent's X-It Electric differs from other products on the market in that only the lock is required to provide an electric locking function whereas other products are usually sold together with a complete door leaf. Often, these other solutions are also comprised of several different components, unlike our lock. This makes Axellent's lock more cost-effective.

Fewer key solutions and more options

Our development of the X-It Electric as a complement to our existing range of locks was driven by customer needs. The product is a refinement of a standard cylinder lock and was initially intended primarily for industrial use. However, to meet growing customer demand for electronic locks even in residential buildings, the X-It Electric was adapted accordingly. An electronic lock makes life easier for residents by simplifying access to shared areas such as laundry rooms, entrances and pram and bike storage rooms. Since the same RFID coding can be used throughout the building, only a single electronic key in the shape of a card or a tag is needed – or else a code lock.

With the X-It Electric, property owners and residents no longer need to keep track of traditional keys. No software needs to be programmed, and the lock is powered solely by electricity (12–24 volts) and is compatible with all access control systems.

A digital lock improves security

When entering and exiting through doors in the building, the tag or card used is recorded in a time log. This enables you to see who has been in different areas at what times. This can be useful in the event of, say, a theft.

What the X-It Electric offers property owners:

- A cost-effective solution.
- Improved security and control in the event of a theft.
- The ability to block an electronic key.
- The freedom to decide who can open which doors.
- The freedom to decide whether you want to use a code lock, tags or keycards.
- Fewer keys.



*With the
focus on
sustainability*



Proximity to manufacturing, wind power and eco-labelled electricity – we think and act green! Choosing our storeroom walls is also a good choice. We have implemented an environmental philosophy throughout our company. We have increased our focus on wind power by becoming a co-owner of a number of wind turbines. This means that we now produce as much green energy as we use.

In our premises, which were ready for occupancy in 2020, 800 solar panels have been installed as yet another part of a sustainable energy supply.

Here at Axelent Safe-X, we are also proud to be involved, through our customers, in initiatives that focus on protecting our environment in such varied locations as residential areas, universities, stations or other places where large numbers of people want to be able to use the bicycle as a means of transport. Making it easier for people to use bikes thanks to our bicycle rack products means that we can be involved in these initiatives.





www.axelentsafex.com



AXELENT SAFE-X AB · BOX 1 · KÄVSJÖVÄGEN 17 · 335 04 HILLERSTORP, SWEDEN
TEL: +46 370 37 34 60 · SALES@AXELENTSAFEX.SE · WWW.AXELENTSAFEX.SE
FOLLOW US ON SOCIAL MEDIA! LINKEDIN: AXELENT SAFE-X YOUTUBE: AXELENT SAFE-X AB